

# COVERROLL WALL ROLLER

## INSTALLATION GUIDE



COVERROLL SUPPORT



# Coveroll Wall Roller - Install Guide

## HOW TO ASSEMBLE ROLLER

### Tools Required



**HAMMER DRILL**  
Brick/Concrete | 12mm masonry drill bit



**DRILL**  
Timber | 10mm drill bit



**17MM SOCKET SPANNER**



**PENCIL/TEXTA**



**HAMMER**



**TAPE MEASURE**



**ANTI-SEIZE**  
Nickle based lubricant



**SPIRIT LEVEL**



**PROTECTIVE BACKING**  
Timber or Plastic



**THREADLOCKER**  
Medium strength ie Loctite



**SUITABLE PPE**  
PPE should be worn while assembling/installing product

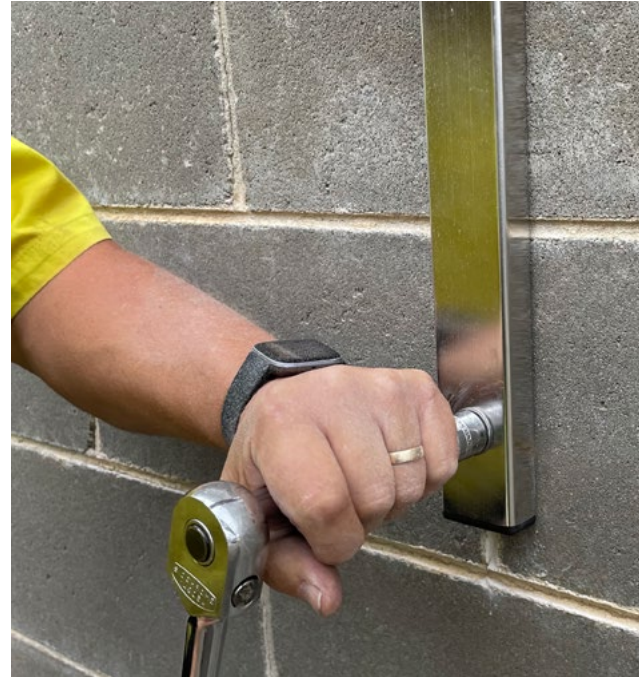

### Supplied Parts



**2 X END FRAMES/  
WALL BRACKET**



**1 X CRANK HANDLE  
WITH M10 SCREW**



**1 X ROLLER TUBE**



**1 X 1.5M ATTACHMENT KIT**

### Fixing Kit Options

#### MASONRY FIXING KIT - 66017



**4 X SLEEVE ANCHOR 12X60MM  
WITH M10 THREAD**  
Concrete/Brick

#### TIMBER FIXING KIT - 66018



**4 X M12 COACH BOLTS**  
Timber



**4 X M10 DOME NUTS**  
Concrete/Brick

#### DISCLAIMER REGARDING WALL TYPES

Ensure the wall (installation location) is structurally capable of accommodating the weight of roller plus cover and sustain the dynamic loads during use. If unsure consult a structural engineer to sign off the structure prior to roller installation. Hollow block walls should be thru-bolted, using a plate at rear to disperse clamping force across multiple blocks. Alternative to use chemset studs and sleeve under structural engineer's approval. Hollow brick walls (i.e 3 or 10-hole red brick) can be fixed using chemset studs and ramset sleeves. When fixing into timber walls, it is critical that all fixings are directly inserted into studs.

# Coverroll Wall Roller - Install Guide

## HOW TO ASSEMBLE ROLLER

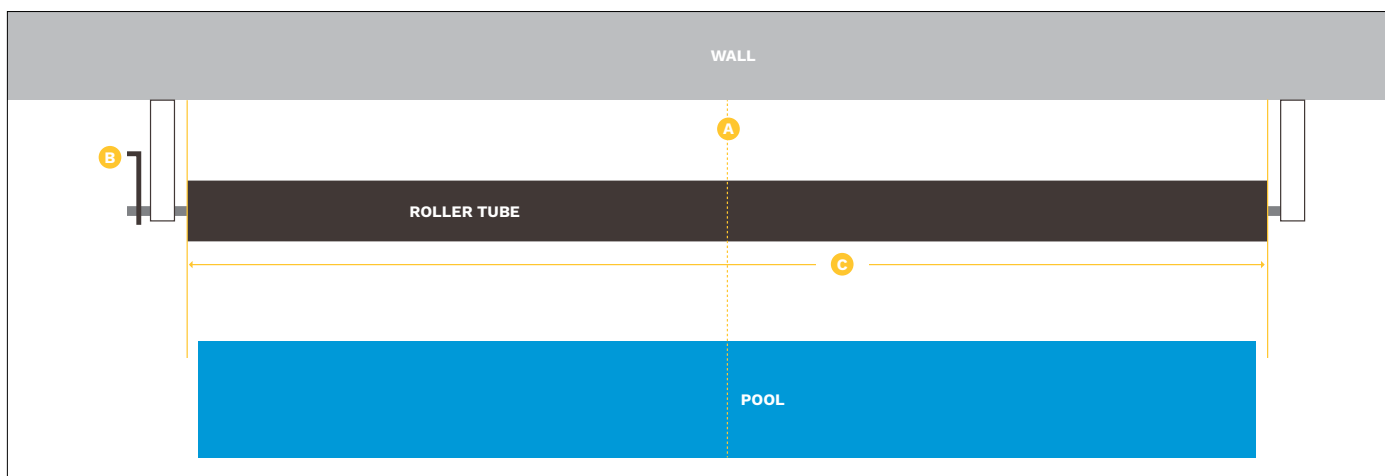

### Roller location setup

- 1. Find Pool Centre:** Measure the entire width of the pool at the end the roller will be installed. Find the centre of this width and mark on the wall (A). This central mark will be your reference point for aligning the roller.
- 2. Determine the Roller's Orientation:** Decide which side of the roller you want the handle to be. The bracket with the t-bolt is where the winder will be positioned (B).
- 3. Find Bracket Bolt Line:** Measure the length of the roller (C) and divide by two. Then add 38mm (D) to the halved length.
- 4. Mark Bracket Bolt Line:** From the center point marked on the wall (A), measure outwards to each side using the length derived in step 3. Mark these points for the bolt line.
- 5. Establish Roller Height:** Choose a suitable height for the roller on the wall, ensuring it is convenient for operation.

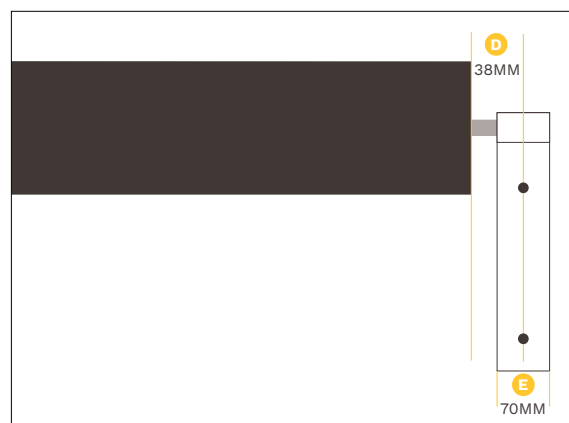

- (A) CENTRE POINT
- (B) ROLLER HANDLE
- (C) ROLLER TUBE LENGTH
- (D) 38MM - OUTSIDE BUNG TO BRACKET CENTRE
- (E) 70MM - BRACKET WIDTH

# Coverroll Wall Roller - Install Guide

## HOW TO ASSEMBLE ROLLER

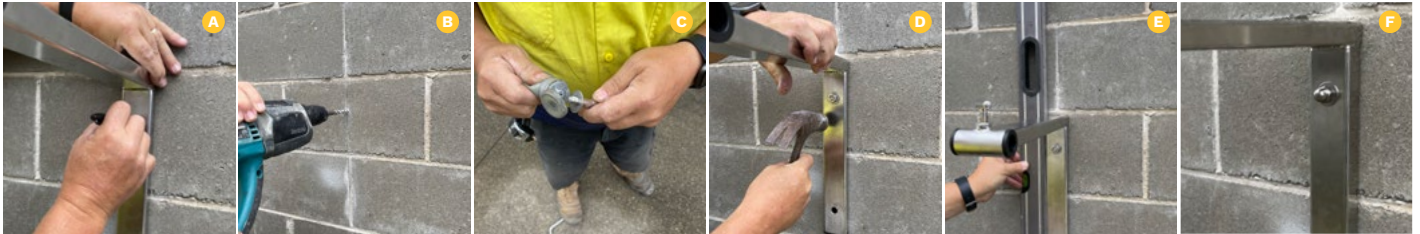

### Installing the first bracket

#### Brick/Concrete wall (option 1)

- 6. Position the First Wall Bracket:** Place the first bracket against the wall. Align the centre of the bracket/bolt line of bracket with the marking made in previous steps. Mark through holes for drilling. **A**
- 7. Drill Holes for Anchors:** Using a hammer drill equipped with a 12mm masonry drill bit, drill the top hole at the marked location to the suitable depth. **B**
- 8. Prepare Sleeve Anchors:** Apply small amount of anti seize to the sleeve anchors to ensure smooth installation. **C**
- 9. Secure the Bracket:** Place the bracket over the drilled holes. Insert the sleeve anchors and tap them into place with a hammer. Tighten loosely to allow for adjustment. **D**
- 10. Level and Adjust the Bracket:** Use a spirit level to check the bracket's position. Rest protective backing (such as timber off-cut) against the wall and bracket to prevent any damage, then lightly tap with a hammer if necessary to achieve level alignment. Then tighten with a 17mm socket. **E**
- 11. Repeat steps for second hole.**
- 12. Attach Dome Nuts:** Remove the standard nuts from the bolts and replace them with dome nuts for a secure and finished appearance. **F**

#### Timber wall (option 2)

- 6. Position the First Wall Bracket:** Place the first bracket against the wall. Align the centre of the bracket/bolt line of bracket with the marking made in previous steps. Mark through holes for drilling.
- 7. Drill Pilot Holes for Coach Bolts:** Using a drill equipped with a 10mm drill bit, drill the top pilot hole at the marked location to a suitable depth for the coach bolt.
- 8. Secure the Bracket:** Place the bracket over the drilled pilot holes. Insert the coach bolts and tighten loosely to allow for adjustment.
- 9. Level and Adjust the Bracket:** Use a spirit level to check the bracket's position. Rest protective backing (such as timber off-cut) against the wall and bracket to prevent any damage, then lightly tap with a hammer if necessary to achieve level alignment. Then tighten with a 17mm socket.
- 10. Repeat steps for second hole.**

# Coveroll Wall Roller - Install Guide

## HOW TO ASSEMBLE ROLLER

### Second bracket and roller install

**11. Positioning the Second Bracket:** Insert the roller shaft into the bracket that has been fixed to the wall. Lift the roller to the approximate position, using a spirit level to ensure it is straight. Check marks on the wall correlate and mark drill locations using the second bracket. **A**

**12. Install the Second Bracket:** Position the second bracket at the marked drill locations. Ensure it is aligned parallel and level with the first bracket. Follow steps 7 to 12 to secure the second bracket. **B C D**

**13. Attach the Crank Handle:** Apply a small amount threadlocker to the M10 bolt. Insert the crank handle into the hole in the roller shaft. Tighten the bolt onto the flat surface of the crank handle to retain rotational movement. **E**

**14. Final Checks:** Once the roller is fully installed, use a spirit level to check both brackets. Operate the crank handle to ensure the roller moves smoothly. If adjustments are needed due to the brackets being misaligned, slightly loosen fixings and lightly tap them with a hammer to realign. Again ensuring you place protective backing against the wall and bracket first to protect from any damage. **F**



REFER TO THE RELEVANT GUIDES FOR  
COVER & ATTACHMENT INSTALLATIONS



MADE IN  
**AUSTRALIA**



A Fluidra Brand

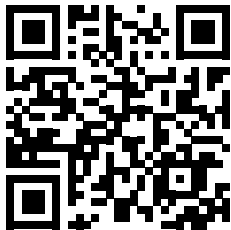

COVERROLL SUPPORT



SUNBATHER  
**1800 228 437**



FLUIDRA  
**1300 MY FLUIDRA**