

COVEROLL PRO GROUND ROLLER

INSTALLATION GUIDE



COVEROLL SUPPORT



Coveroll Pro Ground - Install Guide

HOW TO ASSEMBLE ROLLER

Tools Required



17MM SPANNER



SUITABLE PPE

PPE should be worn while assembling/installing product

Supplied Parts



2 X END FRAMES WITH LOCKABLE CASTOR WHEELS



1 X ROLLER TUBE



1 X CRANK HANDLE WITH M10 BOLT



1 X 1.5M ATTACHMENT KIT

How to Assemble Roller

1. Identify the Drive **A** **E** and Lazy end **B** of the roller tube.
2. Determine which side of the roller you would like the handle to be on. This must use the drive end of the roller which has a hole for the handle. **A** **E**
3. Check the roller tube is wider than the pool. Ideally 150mm on each side. Please see diagram on following page.
4. Remove bolt and washer at lazy end of the roller tube. **B**
5. Lock castor wheels **F**, to prevent end frames moving during assembly. Then thread tube into bushes of end frame. **C**
6. Refit bolt and washer, then tighten with 17mm spanner. **D**
7. Repeat the above steps to fit end frame to drive end of roller tube.
8. Insert crank handle through hole in drive end of tube and tighten bolt onto flat surface of crank handle with 17mm spanner. **E**

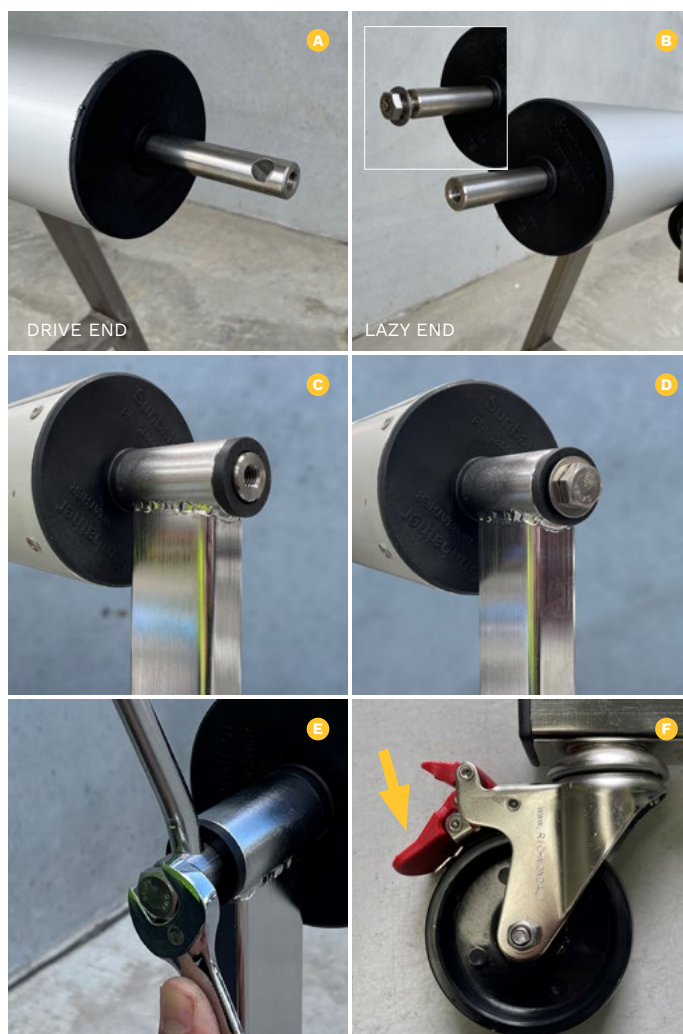

REFER TO THE RELEVANT GUIDES FOR COVER & ATTACHMENT INSTALLATIONS



Coverroll Pro Ground - Install Guide

ROLLER POSITION

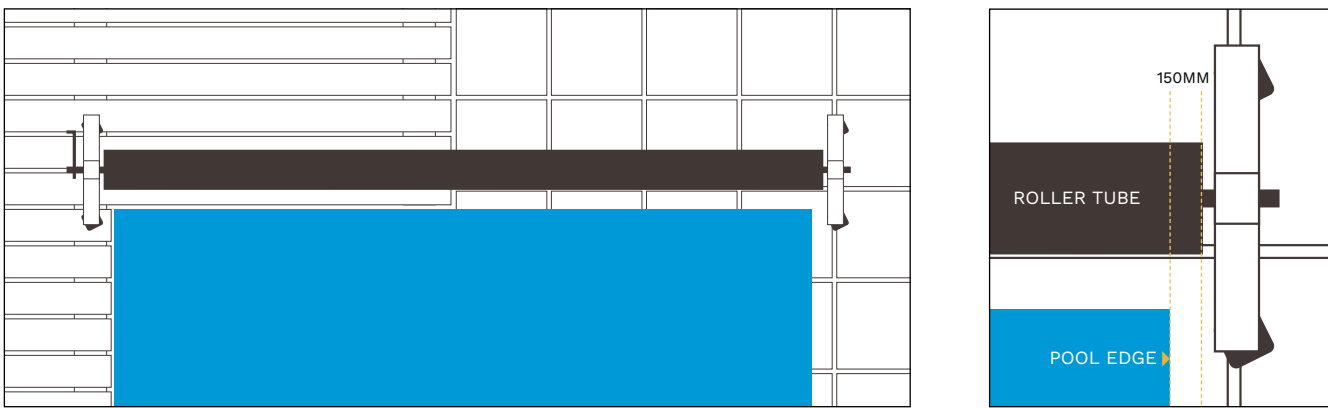

TIP: Ideally the roller tube should be positioned as close to the edge of the coping as possible. This positioning helps the cover lift up and directly onto the roller. Setting the roller too far back creates unnecessary drag and can cause the frames to tip forward.

MADE IN
AUSTRALIA



A Fluidra Brand

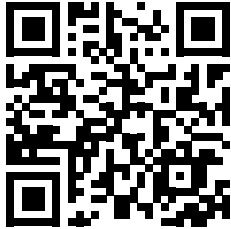

COVERROLL SUPPORT



SUNBATHER
1800 228 437



FLUIDRA
1300 MY FLUIDRA