



A Fluidra Brand

COVEROLL GROUND ROLLER

INSTALLATION GUIDE



COVEROLL SUPPORT



UPGRADE KIT
AVAILABLE
CASTOR WHEELS
& DROP PINS
CODE #66019

Coverroll Ground - Install Guide

HOW TO ASSEMBLE ROLLER

Tools Required



ELECTRIC DRILL
10mm drill bit



PENCIL/TEXTA



17MM SPANNER



TAPE MEASURE



SUITABLE PPE
PPE should be worn while
assembling/installing product

Supplied Parts



2 X END FRAMES
WITH RUBBER FEET



1 X ROLLER TUBE



1 X CRANK HANDLE
WITH M10 BOLT



1 X 1.5M ATTACHMENT KIT

How to Assemble Roller

1. Identify the Drive **E** and Lazy end **B** of the roller.
2. Determine which side of the roller you would like the handle to be on. This must use the drive end of the roller which has a hole for the handle **E**.
3. Check the roller tube is wider than the pool. Ideally 150mm on each side. Please see diagram on following page.
4. Ensure the side of the end frame with the holes in it is closest to the water. **A**.
5. Remove bolt and washer at lazy end of the roller tube **B**.
6. Thread tube into bushes of end frame **C**.
7. Refit bolt and washer, then tighten with 17mm spanner **D**.
8. Repeat the above steps to fit end frame to drive end of roller tube **E**.
9. Insert crank handle through hole in drive end of tube and tighten bolt onto flat surface of crank handle with 17mm spanner **F**.
10. Position the roller so that the end frames are equally spaced from the sides of the pool and align the roller parallel to the end of the pool, so it is just off the water.

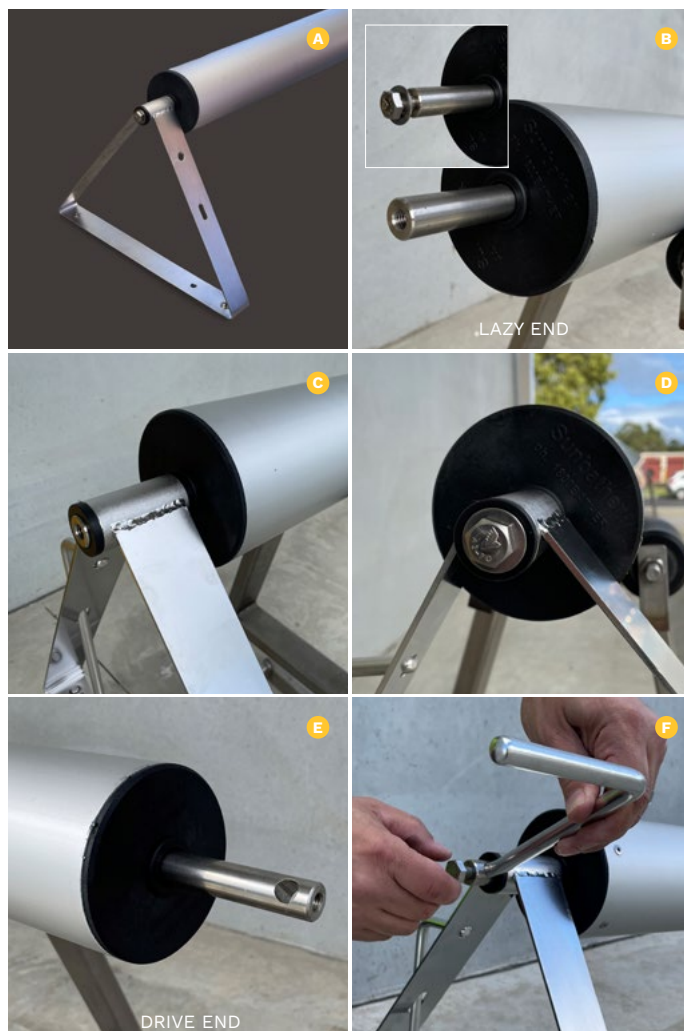

Coverroll Ground - Install Guide

HOW TO ASSEMBLE ROLLER

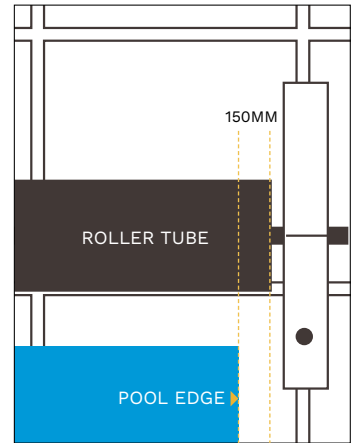
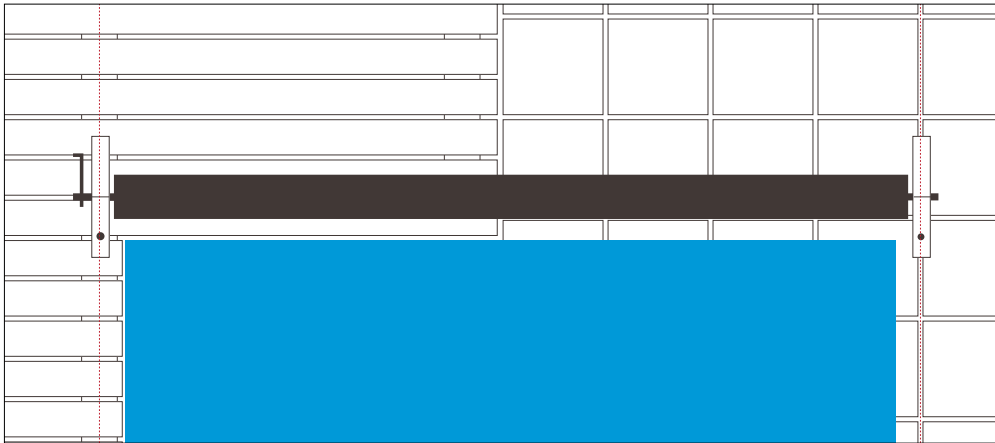

TIP: Ideally the roller tube should be positioned as close to the edge of the coping as possible. This positioning helps the cover lift up and directly onto the roller. Setting the roller too far back creates unnecessary drag and can cause the frames to tip forward.

REFER TO THE RELEVANT GUIDES FOR
COVER & ATTACHMENT INSTALLATIONS



MADE IN
AUSTRALIA



A Fluidra Brand

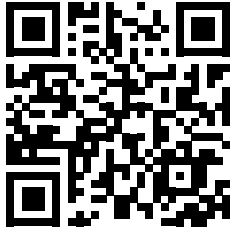

COVERROLL SUPPORT



SUNBATHER
1800 228 437



FLUIDRA
1300 MY FLUIDRA